

**WALKER COUNTY GOVERNMENT
LANDFILL SITE DECISION MEETING
Walker County Courthouse Annex III
201 South Main Street
LaFayette, Georgia 30768**

Date: Thursday, September 13, 2018



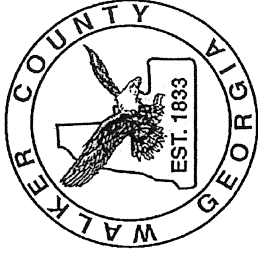

Time: 5:00 PM

Agenda items:

- I. Welcome and Introduction
- II. Facility Background and Purpose of Meeting
- III. Siting Decision
- IV. Public Comments or Questions
- V. Adjourn



Legend

-  county polygon
-  towns polygon
-  Expansion Site
-  Existing Landfills

Parcels from Walker County Tax Assessors website.

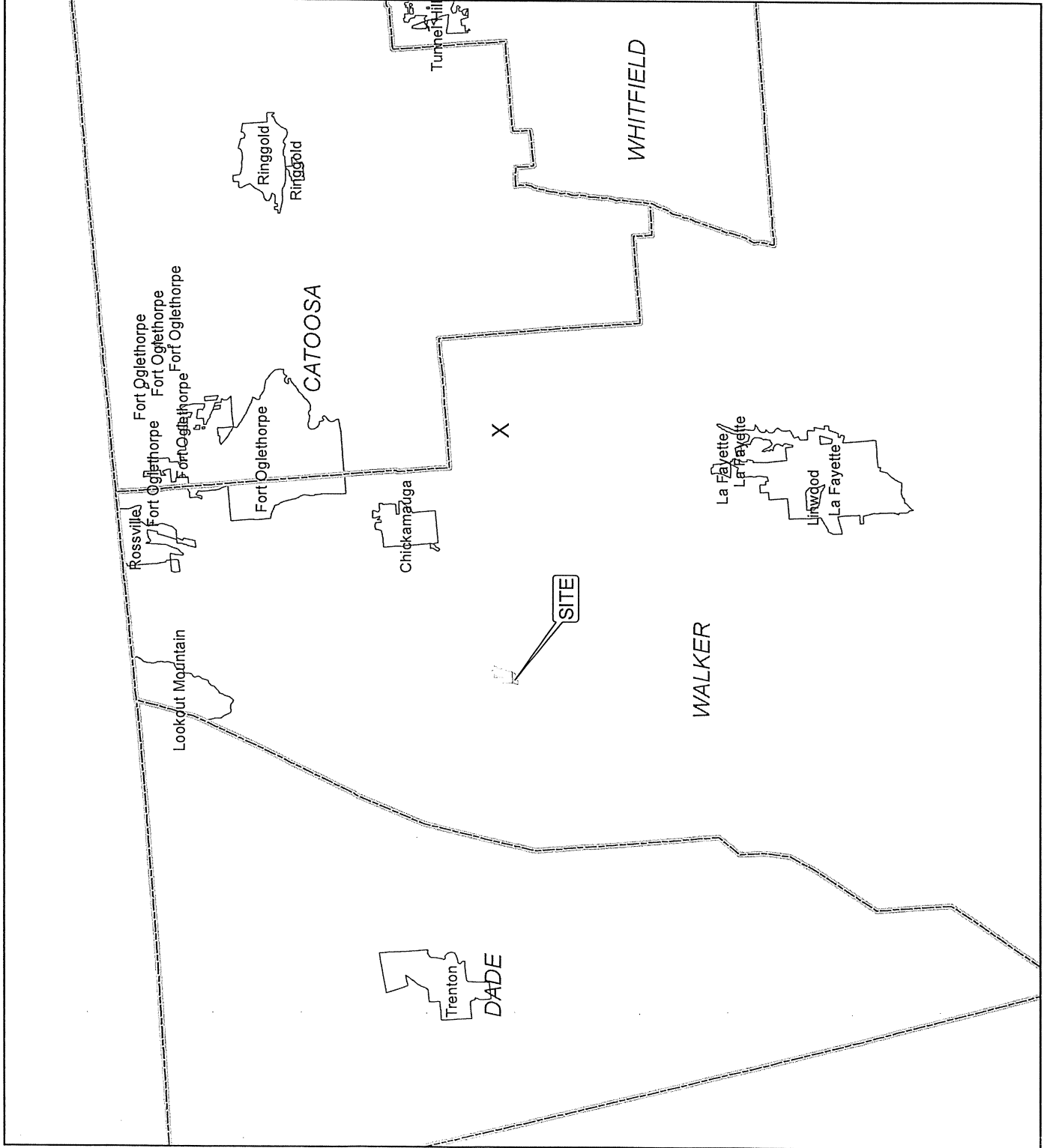
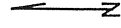
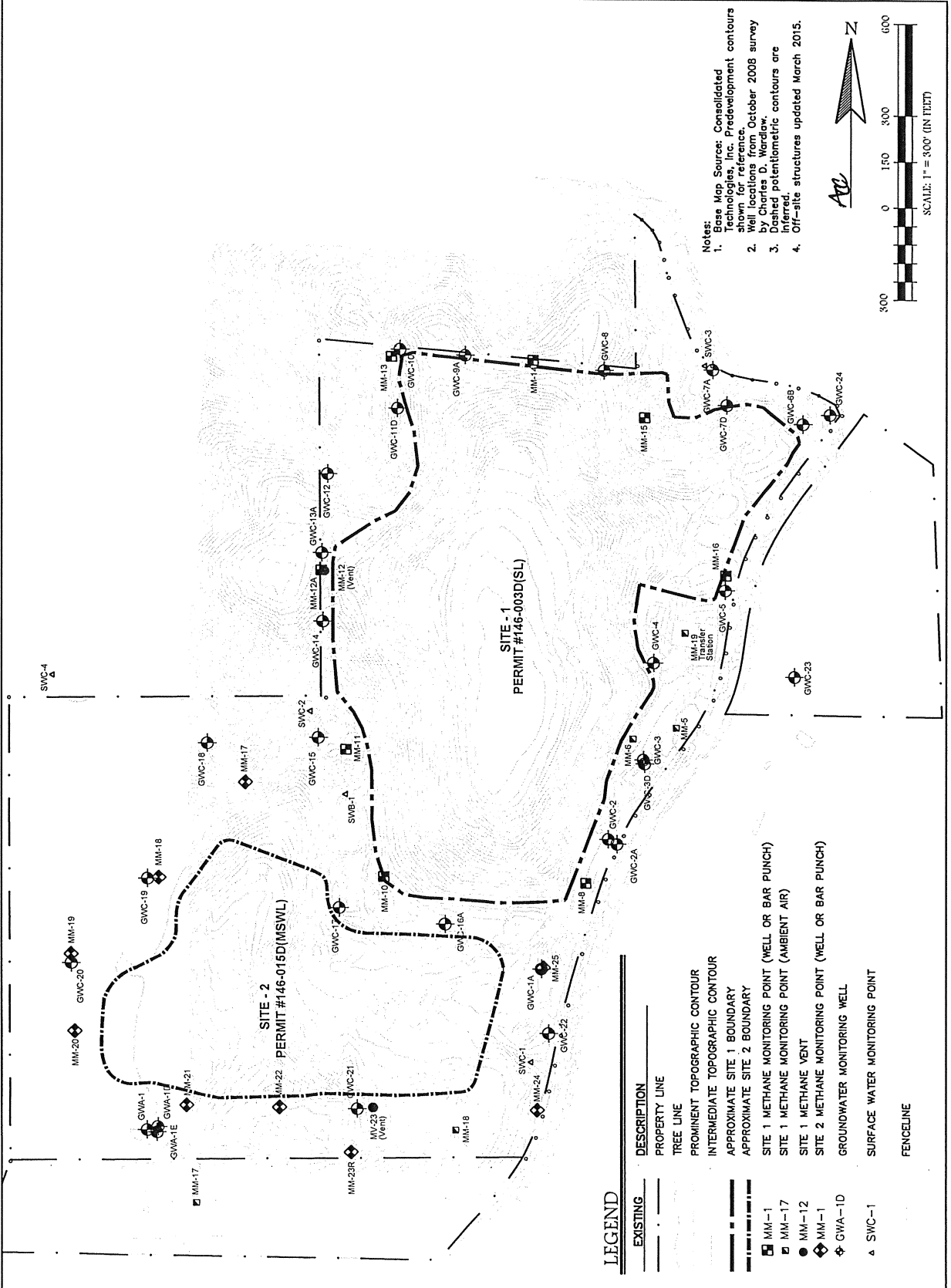

Figure 1
Site Location Map
Walker County, GA





ATLANTIC COAST
CONSULTING, INC.
650 Colonial Park Drive
Suite 110
Roswell, GA 30075
☎ 770.594.5998
F 770.594.5987
www.atkcc.net

PROJECT
**MARBLE TOP
ROAD LANDFILL
SITES 1 AND 2**
Site 1 Permit #146-003D
Site 2 Permit #146-015D
WALKER COUNTY, GA

WALKER
COUNTY

Walker County Government
3142 North Marble Top Road
Cleveland, GA 30537
770.375.8310

PROJECT CA APPROVAL: MAM

PROJECT NUMBER
GC031-106
August 2018

CONCEPTUAL
EXPANSION
AREA

FIGURE 3

- Notes:
1. Base Map Source: Consolidated Technologies, Inc. Predevelopment contours shown for reference.
 2. Well locations from October 2008 survey by Charles D. Wardlaw.
 3. Off-site structures updated March 2015.

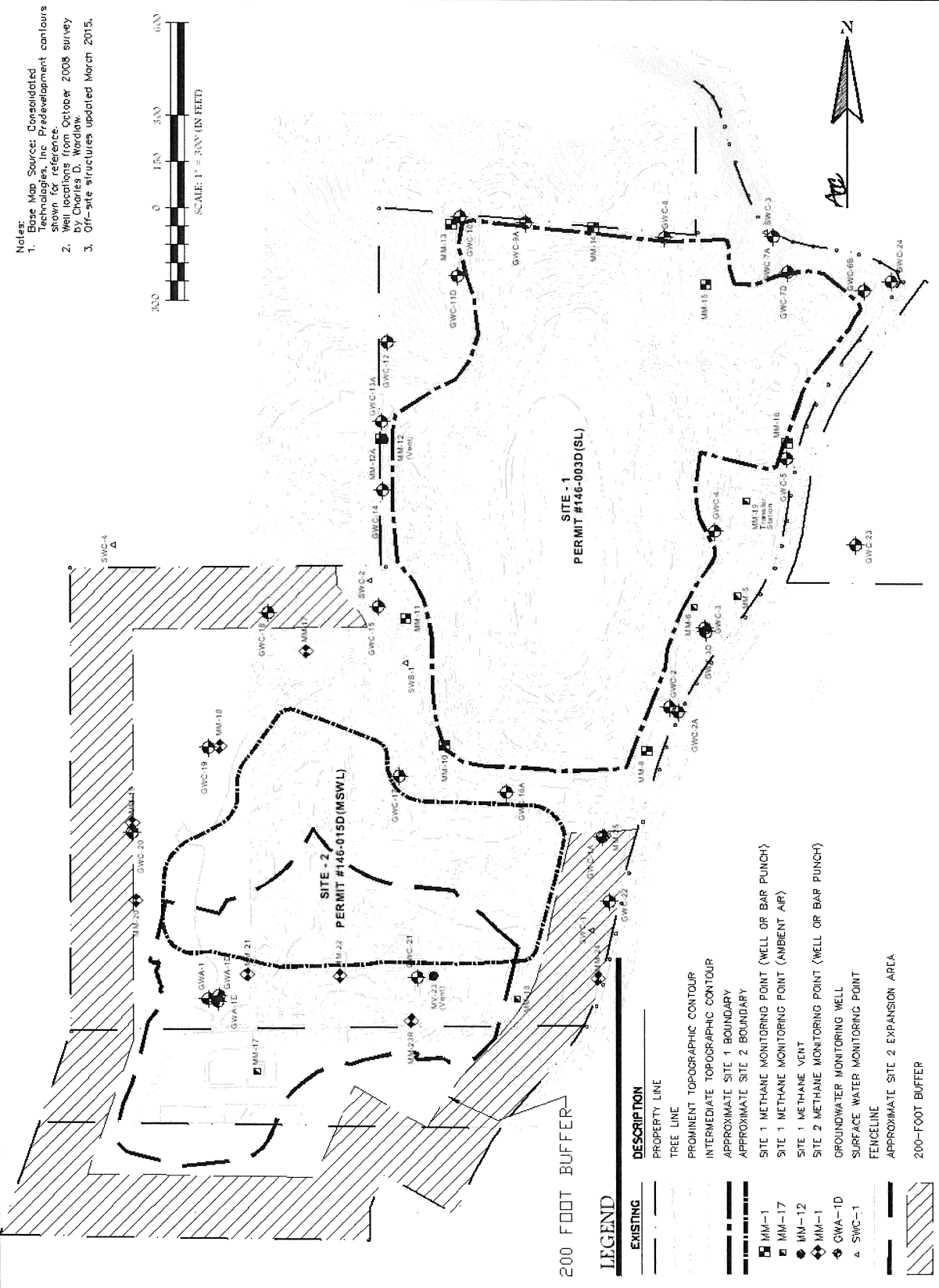
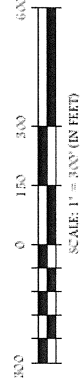

LEGEND

EXISTING	DESCRIPTION
—	PROPERTY LINE
—	TREE LINE
—	PROMINENT TOPOGRAPHIC CONTOUR
—	INTERMEDIATE TOPOGRAPHIC CONTOUR
—	APPROXIMATE SITE 1 BOUNDARY
—	APPROXIMATE SITE 2 BOUNDARY
■	SITE 1 METHANE MONITORING POINT (WELL OR BAR PUNCH)
◆	SITE 1 METHANE MONITORING POINT (AMBIENT AIR)
◆	SITE 2 METHANE MONITORING POINT (WELL OR BAR PUNCH)
◆	SITE 2 METHANE MONITORING POINT (AMBIENT AIR)
◆	GROUNDWATER MONITORING WELL
◆	SURFACE WATER MONITORING POINT
—	FENCELINE
—	APPROXIMATE SITE 2 EXPANSION AREA
—	200-FOOT BUFFER